

**1. DONJA EAZA P= 40,49m<sup>2</sup>**

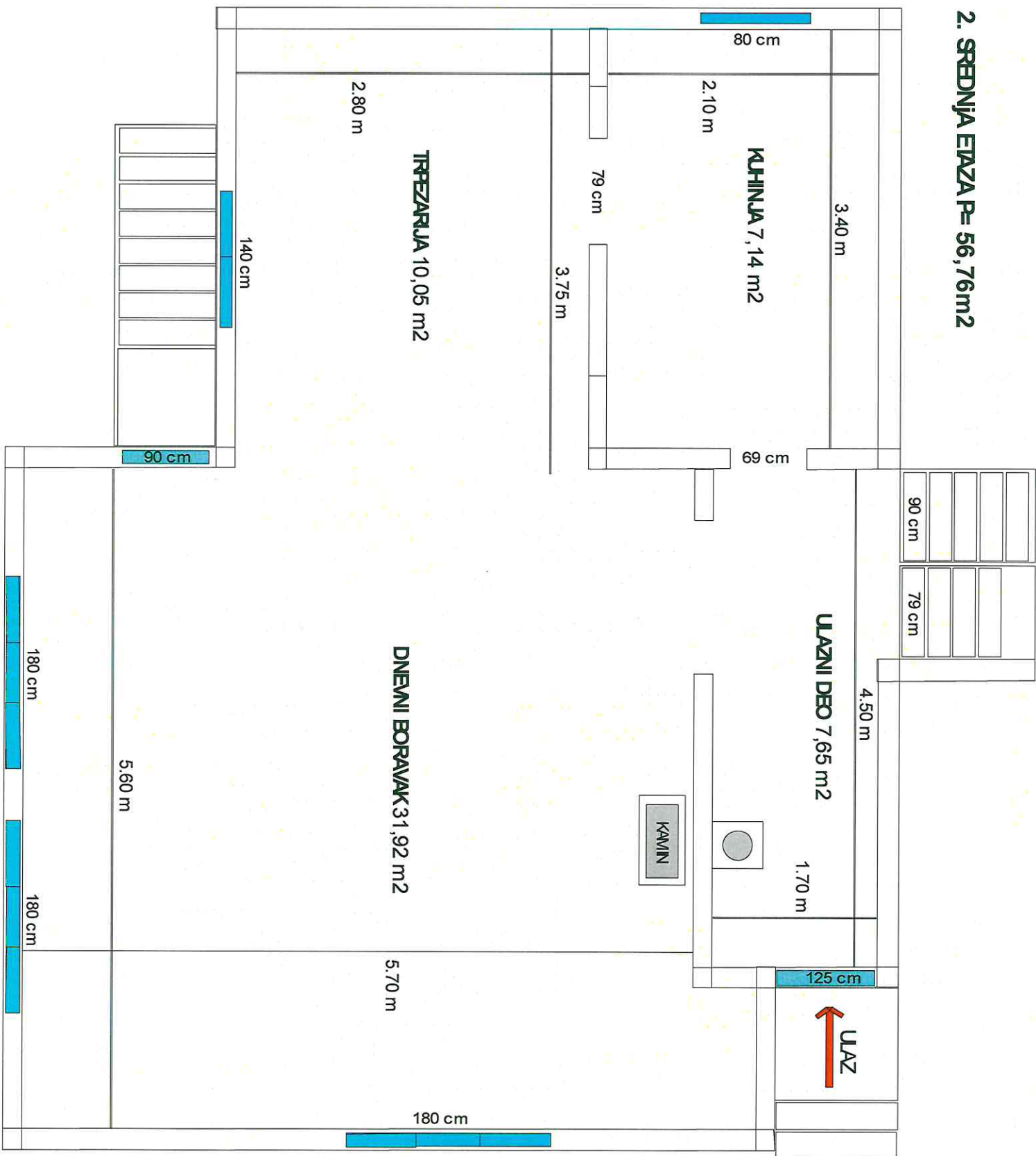

**2. SREDNJA ETAZA P= 56,76m<sup>2</sup>**



### 3. GONJA EWAZA - SPAVACI DEO 45.78 m<sup>2</sup>





**4. POTKROVLJE P= 66.03 m<sup>2</sup>**

**POTKROVLJE 48.36 m<sup>2</sup>**

3,10 m

**LODŽIA 17.67 m<sup>2</sup>**

5,70 m

120 cm

120 cm

100 cm

140 cm

5,20 m

9,30 m

110 cm

245 cm

245 cm

TAVAN LAZSA GORŃE ETAZE

CAJNA KLHNA 62 cm

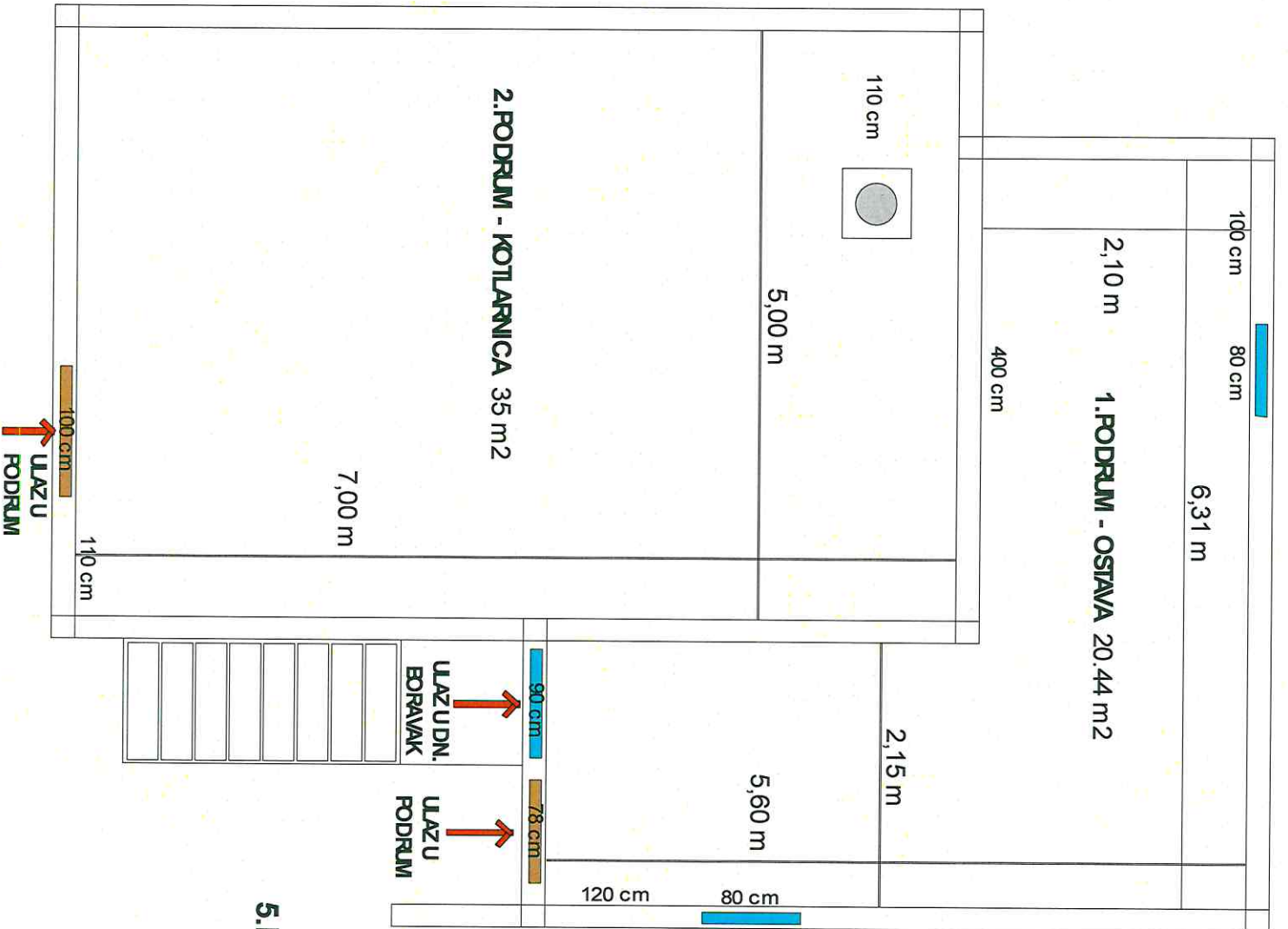

**5. PODRUM I P= 55.44 m<sup>2</sup>**